

FIRST FLOOR PLAN
PRELIMINARY USE ONLY

NOTES:

- 1.) WINDOWS SIZES IN SLEEPING ROOMS ARE DESIGNED TO BE THE LIFT OUT (REMOVABLE) TYPE UNITS WHICH COMPLY WITH SECTION R 310 EMERGENCY EGRESS OF THE 2003 INTERNATIONAL RESIDENTIAL CODE.
- 2.) ALL INTERIOR PARTITIONS ARE 4" WIDE UNLESS OTHERWISE NOTED.
- 3.) FIREPLACE & HEARTH TO BE CONSTRUCTED IN COMPLIANCE WITH LOCAL BUILDING CODE. SIZE TO BE DETERMINED BY OWNER.
- 4.) OLD VIRGINIA HAND HEWN LOG HOMES, INC. ASSUMES NO RESPONSIBILITY FOR ANY CHANGES TO THIS PLAN UNLESS SUBMITTED TO THIS OFFICE IN WRITING.
- 5.) ALL EXTERIOR WINDOWS AND DOORS ARE DESIGNED FOR 1" x 6" TRIM.

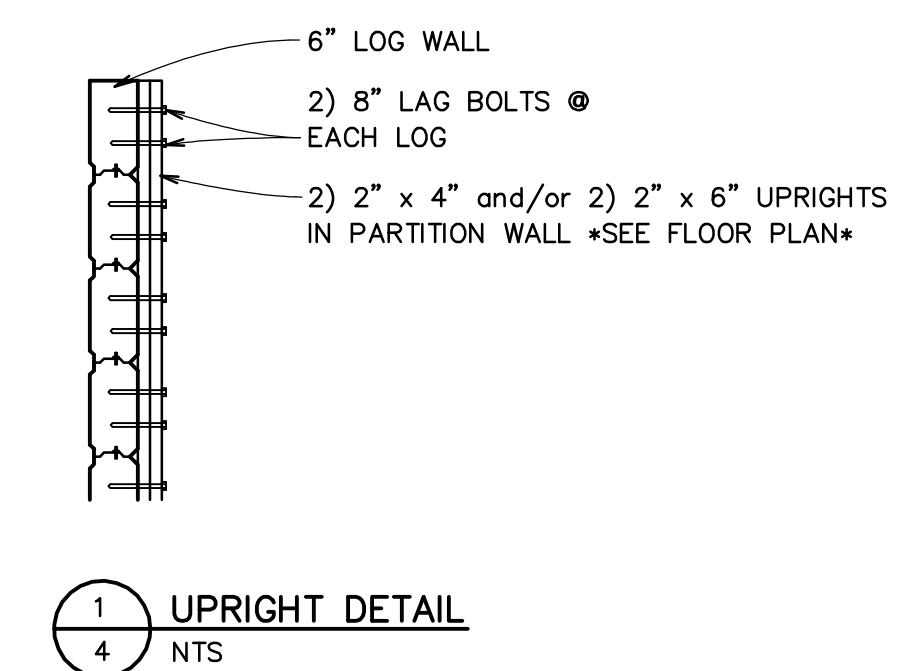

CAUTION !!!!!
DO NOT USE DIMENSIONS ON THIS PAGE FOR FOUNDATION! REFER TO FOUNDATION SHEET FOR FOUNDATION DIMENSIONS AND ABIDE BY ALL THAT IS NOTED.
CHECK WITH LOCAL BUILDING CODES BEFORE STARTING CONSTRUCTION.

This document, including the ideas and designs incorporated herein, as an instrument of professional service, is the property of Old Virginia Hand Hewn Log Homes, Inc. and may not be used in whole or in part for construction other than Old Virginia Hand Hewn Log Homes, Inc.

ALL WORK TO BE DONE IN ACCORDANCE WITH APPLICABLE BUILDING CODES



Old Virginia Hand Hewn Log Homes, Inc.

SCALE: 1/4"=1'-0"	DRAWN BY: B. BALES	APPRVD:
DATE: 12-10-2015	REV:	
PLAN FOR:		
FIRST FLOOR PLAN		
BLUE RIDGE BARN		SHEET 4 of 9