

**FIRST FLOOR PLAN**

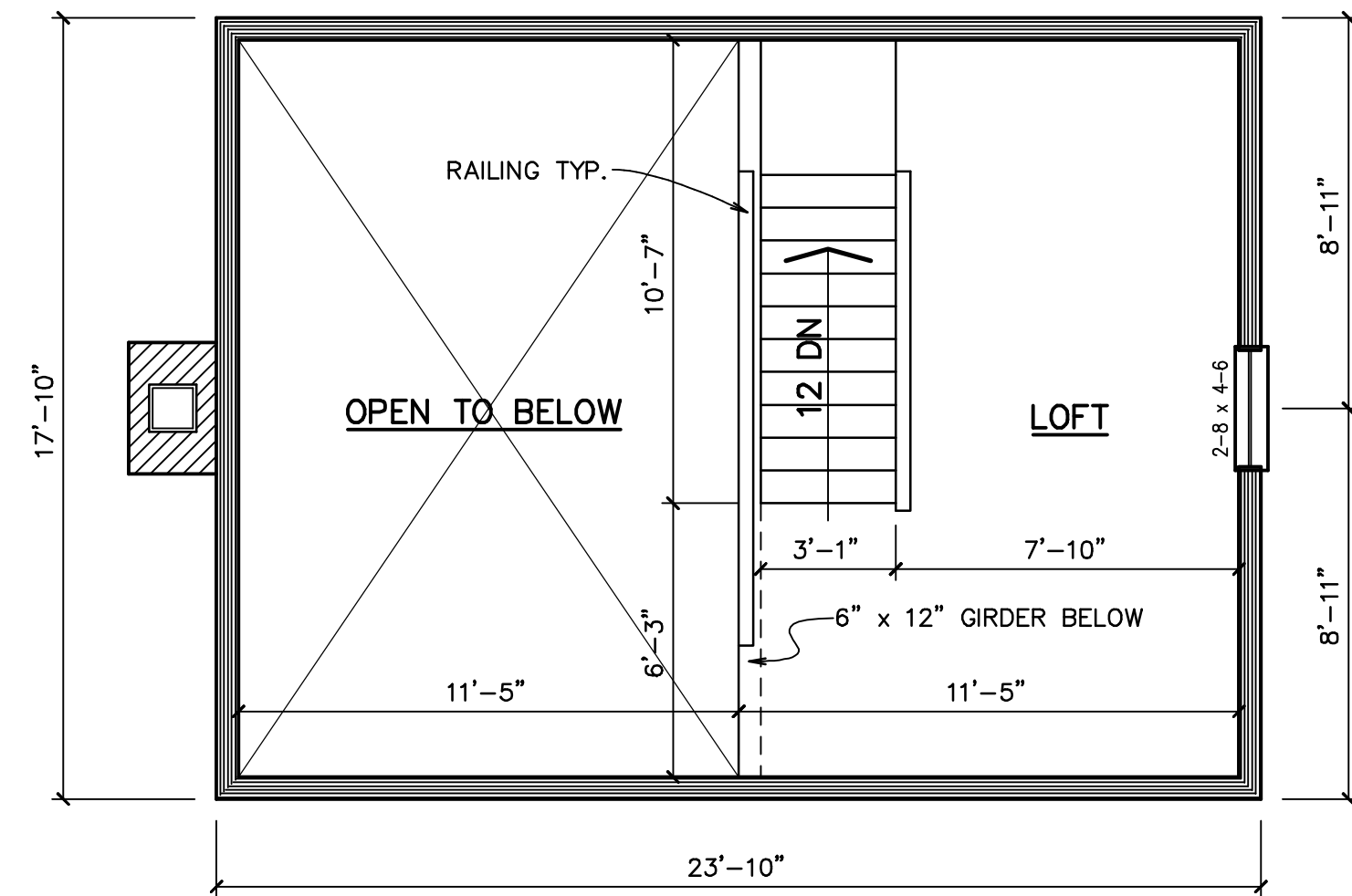

**SECOND FLOOR PLAN**

**NOTES:**

- 1.) WINDOWS SIZES IN SLEEPING ROOMS ARE DESIGNED TO BE THE LIFT OUT (REMOVABLE) TYPE UNITS WHICH COMPLY WITH SECTION R 310.2 EMERGENCY EGRESS OF THE 1995 CABO ONE AND TWO FAMILY DWELLING CODE.
- 2.) ALL INTERIOR PARTITIONS ARE 4" WIDE UNLESS OTHERWISE NOTED.
- 3.) FIREPLACE & HEARTH TO BE CONSTRUCTED IN COMPLIANCE WITH LOCAL BUILDING CODE. SIZE TO BE DETERMINED BY OWNER.
- 4.) OLD VIRGINIA HAND HEWN LOG HOMES, INC. ASSUMES NO RESPONSIBILITY FOR ANY CHANGES TO THIS PLAN UNLESS SUBMITTED TO THIS OFFICE IN WRITING.
- 5.) ALL EXTERIOR WINDOWS AND DOORS ARE DESIGNED FOR 1" x 6" TRIM.

**CAUTION !!!!!**

DO NOT USE DIMENSIONS ON THIS PAGE FOR FOUNDATION! REFER TO FOUNDATION SHEET FOR FOUNDATION DIMENSIONS AND ABIDE BY ALL THAT IS NOTED. CHECK WITH LOCAL BUILDING CODES BEFORE STARTING CONSTRUCTION.



*Old Virginia Hand Hewn Log Homes, Inc.*

Route 2, Box 455A  
Pennington Gap, VA 24277  
(540) 548-5647

|                                       |                 |                 |
|---------------------------------------|-----------------|-----------------|
| SCALE 1/4"=1'-0"                      | DRAWN BY R.DEEL | APPRVD.         |
| DATE 7-15-99                          | REV.            |                 |
| PLAN FOR:                             |                 |                 |
| <b>FIRST &amp; SECOND FLOOR PLANS</b> |                 |                 |
| <b>ROCKY TOP</b>                      |                 | SHEET<br>3 of 5 |